

DEVELOPMENT VARIANCE PERMIT NO. VP100651

1100 Patricia Blvd. | Prince George, BC, Canada V2L 3V9 | www.princegeorge.ca

- 1) This Development Variance Permit is issued to:

Name: Michael Gervais
Address: 10365 Western Road
Prince George, BC V2N 6M9

- 2) This Development Variance Permit applies to:

Address: 10365 Western Road
Legal Description: Lot 20, District Lot 625, Cariboo District, Plan 13646

- 3) This permit is issued subject to compliance with all of the Bylaws of the City of Prince George applicable thereto, except as specifically varied by this permit.

- 4) This permit varies **Sections 10.1.6 1. and 10.1.6 2. of City of Prince George Zoning Bylaw No. 7850, 2007** as follows:

- a. Increase the maximum total combined gross floor area of accessory buildings and structures on a site from 90.0 m² to 136.0 m²; and
- b. Increase the maximum height of accessory development from 5.0 m to 7.0 m.

The variance is only granted for the construction of a 136.0 m² accessory building, as shown on Exhibits "A" and "B" to VP100651.

- 5) If a Building Permit for the development permitted by this permit has not been issued and construction substantially commenced within **two years** after the date of this permit's issuance, this permit shall lapse.

- 6) **This Development Variance Permit is not a Building Permit.**

- 7) **This Development Variance Permit does not satisfy any other approvals required by the City of Prince George, the Province of British Columbia, or the Federal Government.**

Authorizing resolution passed by Mayor and Council on ____ day of _____, 2023.



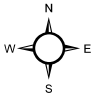

Issuance date: _____

Authorizing Signature: _____

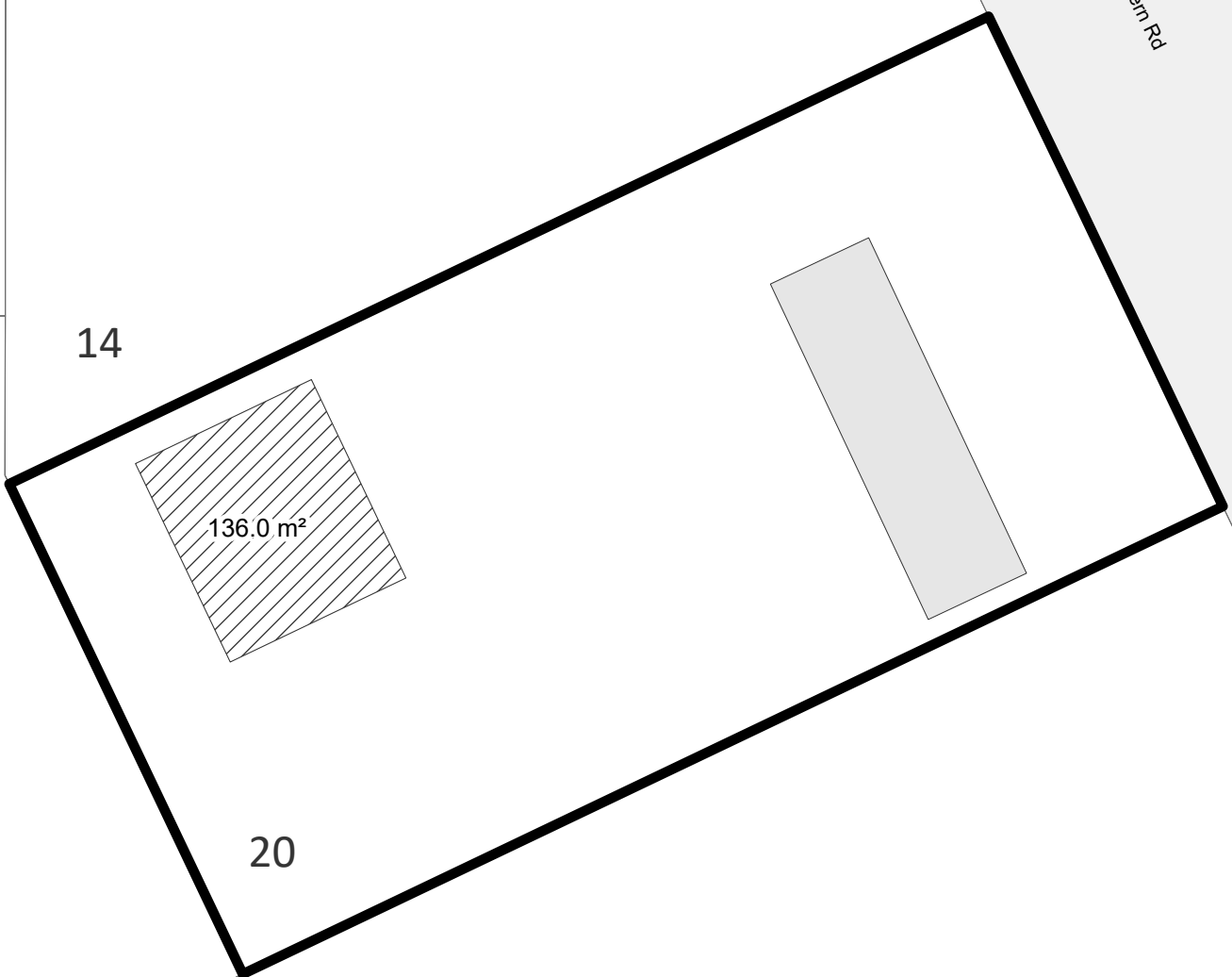

Vary Section 10.1.6 1. of the City of Prince George Zoning Bylaw No. 7850, 2007 to increase the total maximum combined gross floor area of accessory buildings and structures on a site from 90.0 m² to 136.0 m².



-  Subject Parcel
-  Existing Residence
-  Proposed Accessory Building
-  Parcel

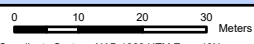

Coordinate System: NAD 1983 UTM Zone 10N
Projection: Transverse Mercator
Datum: North American 1983

1:400

Exhibit "A" to VP100651
Lot 20, DL 625, CD, Plan 13646



To vary section 10.1.6.2 of the City of Prince George Zoning Bylaw No. 7850, 2007 to increase the maximum height of an accessory development from 5.0 m to 7.0 m.

